

June 2020

Dear Sir or Madam,

Please accept this document as a formal notification that SYLEX is replacing the currently used MTP[®] boots (US Conec PN – 8041) with MTP[®] PRO push-pull boots (US Conec PN - 21442) within the MTP[®] PRO connector. This change is based on our personal decision as we consider the new MTP[®] PRO push-pull boot to be more practical in-field, utilising all features of a standard MTP[®] boot while additionally offering the push-pull option.

Below you will find a comparison of the current and upcoming designs of MTP[®] boots.

Currently used MTP[®] boots (dimensions in mm):

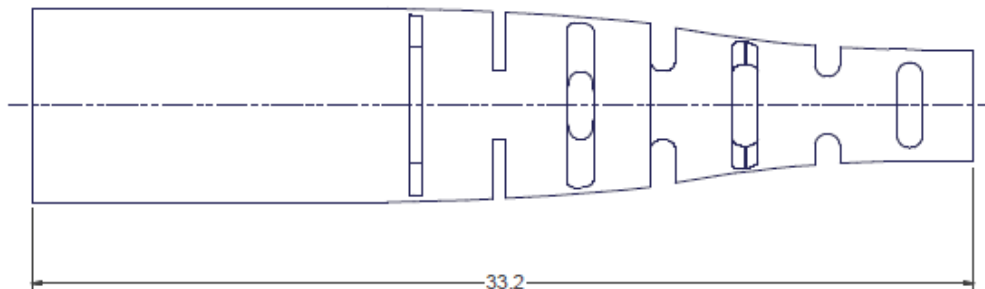

Upcoming MTP[®] PRO push-pull boots (dimensions in mm):

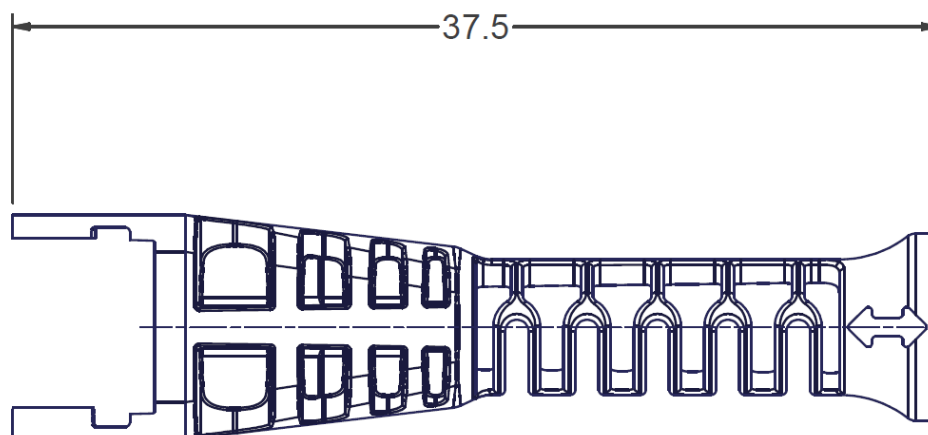

Product change notification PCN-FOI-017

Please find these MTP[®] boots compared “in use” in the pictures here:

Currently used:



To be used:



In-field comparison:

MTP[®] boot:



MTP[®] PRO push-pull boot:



For detailed information, please contact your primary SYLEX representative.

This change will be implemented immediately, on this PCN's release date.

Sincerely,

Your SYLEX team